

LV0123

20W LED WORK LIGHT FLOOD BEAM

- Die-cast aluminium housing
- Polycarbonate lens
- 40° beam pattern
- Stainless steel mounting hardware
- Silicone cable w/ DT connector
- Operating temperature: -40°C to +60°C
- Current draw: 1.4A @ 12V DC

DIMENSIONS:

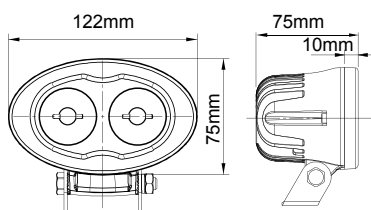

BLUE LEDS



PRODUCT INFORMATION

LV0123B 6W Blue 10° spot beam

LV0123S 20W 10° spot beam

LV0253

24W LED WORK LIGHT FLOOD BEAM

- Die-cast aluminium housing
- Polycarbonate lens
- 40° beam pattern
- Stainless steel mounting hardware
- Pre-wired 200mm cable
- Operating temperature: -30°C to +50°C
- Current draw: 1.75A @ 12V DC

DIMENSIONS:

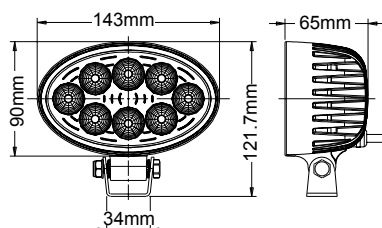

LV9040

27W HEAVY DUTY BLUE LED LIGHT SPOT BEAM

- Die-cast aluminium housing
- Polycarbonate lens
- 10° beam pattern
- Stainless steel mounting hardware
- Silicone cable w/ DT connector
- Operating temperature: -40°C to +50°C
- Current draw: 1.27A @ 12V DC

DIMENSIONS:

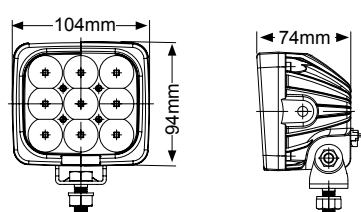

BLUE LEDS

