

Product Release



LV9131

30W LED CURVED WORK / REVERSE LIGHT 120° WIDE FLOOD BEAM

Barcode: 9342828239486



**ECE APPROVED FOR
REVERSE ECE-R23**



Features:

- Can be used for work or reverse light
- 3 x 10W LEDs Flood
- 9-36 Volt DC Input
- 120° Wide Flood Beam
- Die Cast Aluminium Housing
- Powder Coated Finish
- Polycarbonate Lens
- 180° Adjustable Stainless Steel Mounting Bracket
- Electronic Thermal Management
- Deutsch Connector
- Lumens: 3200 Raw, 2500 Effective
- 1Lux @54 metres
- Colour Temp: 5700K
- Current Draw: 2.3A @12V, 1.1A @24V
- Operating Temperature: -40°C to +60°C
- IP68 & IP69K
- Approved by ECE R10 & ECE R23
- EMC: CISPR25 Class 3
- 3 In 1 Optical System
- Measurements: 145 x 51.8 x 75mm
- Can be used with Time Delay Module: **LV0197**



Product Release

LV9131

30W LED CURVED WORK / REVERSE LIGHT 120° WIDE FLOOD BEAM

This work light has a multi-functional bracket. More than 180 degrees of adjustability. But not only that it has 2 holes in the side brackets. Giving the choice of the height of the light in the bracket also.

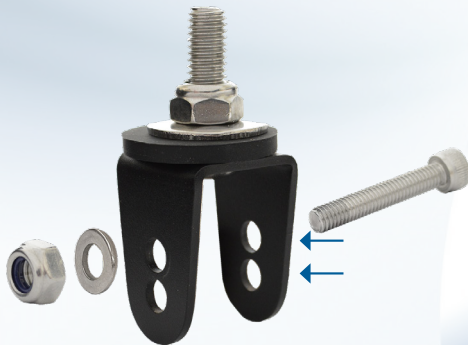

**2 HOLES ON
THE BRACKET**



This light can be ideally suited with **LV0197**, reverse time delay module.



Beam Pattern:

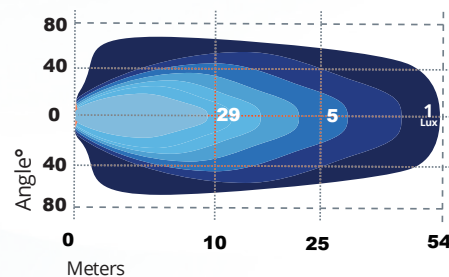

Dimensions:

